

EIN TOOLS



 **ALFA'R CONNECTORS**

ÍNDICE

INDEX

<i>CODE</i>		<i>CODE</i>	
CÓDIGO	Pág.	CÓDIGO	Pág.
A-EIN-C-0-51	8	-PCR-A-RG	5
-C-0-52	8	-PCR-A-TA	5
-C-0-341	8	-PCR-A-VC	5
-C-0-342	8	-PCR-A-VD	5
-C-0-631	8	-PC-B	6
-C-0-632	8	-PCR-B-A	6
-C-0-641	8	-PCR-B-B	6
-C-0-642	8	-PCR-U	5
-C-0-931	8	-PCR-X	4
-C-0-932	8		
-C-0-B2	8		
-C-0-C61	8		
-C-0-D2	8		
-C-0-H3K	8		
-C-0-HJK	8		
-C-0-JIK	8		
-C-1	8		
-C-1-51	7		
-C-1-52	7		
-C-1-341	7		
-C-1-342	7		
-C-1-641	7		
-C-1-642	7		
-C-1-931	7		
-C-1-932	7		
-C-1-C61	7		
-C-1-H3K	7		
-C-1-HJK	7		
-C-1-JIK	7		
-C-2	8		
-C-2-B2	7		
-C-2-D2	7		
-CF-1/2X3	11		
-CF-5X2	11		
-CF-6X2	11		
-CF-7X3	11		
-CF-8X3	11		
-CF-9X3	11		
-CF-10X3	11		
-CF-11X3	11		
-CF-12X3	11		
-CF-13X3	11		
-CF-14X4	11		
-CF-15X4	11		
-CF-16X4	11		
-CF-17X4	11		
-CF-18X4	11		
-CF-19X4	11		
-CF-20X4	11		
-CF-21X6	11		
-CF-22X6	11		
-CF-23X6	11		
-CF-24X6	11		
-CF-25X9	11		
-CF-27X9	11		
-CF-30X9	11		
-CF-32X9	11		
-MT-F	9		
-MTR-5/8	9		
-MTR-F-61	9		
-MTR-F-68	9		
-MTR-F-88	9		
-MTR-F-99A	9		
-MTR-F-102	9		
-MTR-F-103A	9		
-MT-SMA	10		
-PC-160Z-A	3		
-PC-160Z-B	3		
-PCR-160Z-A	3		
-PCR-160Z-B	3		
V-EIN-C-5-EFG	7		
-MT-1,6	10		
-MT-F-A	10		
-PC-155X	3		
-PC-199X-A	3		
-PC-199X-B	3		
-PC-A	5		
-PC-C	6		
-PC-D	6		
-PC-U	4		
-PC-U-A	5		
-PC-U-B	5		
-PC-X	4		
-PCR-155X	3		
-PCR-199X-A	3		
-PCR-199X-B	3		
-PCR-A-A	5		
-PCR-A-BU	5		
-PCR-A-GC	5		
-PCR-A-GS	5		
-PCR-A-MR	5		
-PCR-A-NG	5		

Herramientas para la preparación del cable

Tools for cable preparation

cable CF1/2"Cu 2Y

CF1/2"Cu 2Y cable

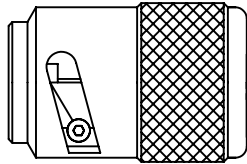

fig. 1

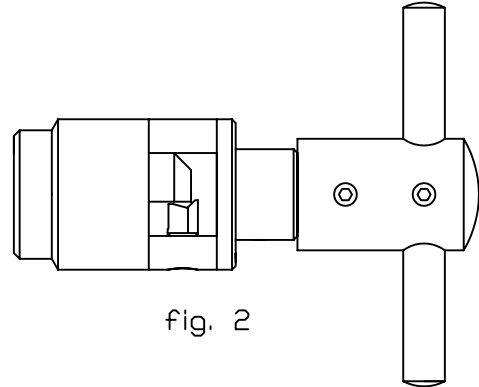

fig. 2

NOTE NOTA		ALFA'R CODE CÓDIGO ALFA'R	FIG. FIG.
<i>jacket stripping tool</i> herramienta para quitar la cubierta del cable		A-EIN-PC-160Z-A	1
<i>spare blade</i> cuchilla de recambio		A-EIN-PCR-160Z-A	
<i>dielectric/sheath cutting tool</i> herramienta para cortar dieléctrico y pantalla		A-EIN-PC-160Z-B	2
<i>spare blades kit</i> juego cuchillas de recambio		A-EIN-PCR-160Z-B	

cable troncal (CATV)

trunk cable (CATV)

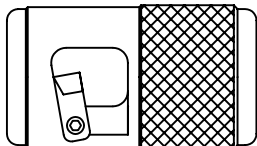

fig. 1

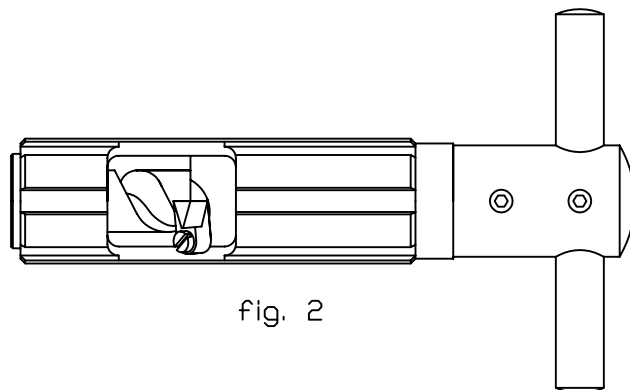
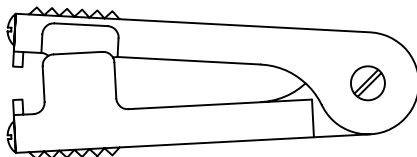

fig. 2

NOTE NOTA	CABLE CABLE	ALFA'R CODE CÓDIGO ALFA'R	FIG. FIG.
<i>jacket stripping tool</i> herramienta para quitar la cubierta del cable	4.22/17.42/18.16	V-EIN-PC-199X-A	1
<i>spare blade</i> cuchilla de recambio		V-EIN-PCR-199X-A	
<i>dielectric coring and sheath cutting tool</i> herramienta para vaciar dieléctrico y cortar pantalla	4.22/17.42/18.16	V-EIN-PC-199X-B	2
<i>spare blade kit</i> juego cuchillas de recambio		V-EIN-PCR-199X-B	
<i>dielectric coring/sheath and jacket cutting tool</i> herr. vaciar dieléctrico, cortar pantalla y cubierta	QR-540	V-EIN-PC-155X	
<i>spare blades kit</i> juego cuchillas de recambio		V-EIN-PCR-155X	

herramienta limpieza conductor central
(cables troncales)

*center conductor cleaner tool
(trunk cables)*



<i>NOTE</i>		<i>ALFA`R CODE</i>	
NOTA		CÓDIGO ALFA`R	
<i>tool</i>	herramienta	V-EIN-PC-X	
<i>spare</i>	recambio	V-EIN-PCR-X	

peladora universal

universal stripper

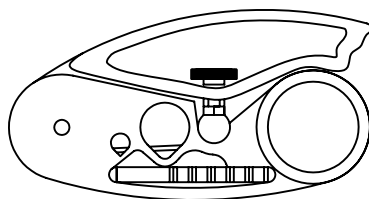

<i>NOTE</i>		<i>ALFA`R CODE</i>	
NOTA		CÓDIGO ALFA`R	
<i>12.5∅ max. cable jacket and copper to 4mm²</i>	cubierta cable ∅max.12.5 y de cobre hasta 4 mm ²	V-EIN-PC-U	

peladora de cubierta
(profundidad de corte
ajustable max. 4.5mm)

*jacket stripping tool
(cut adjustment depth
max. 4.5mm)*

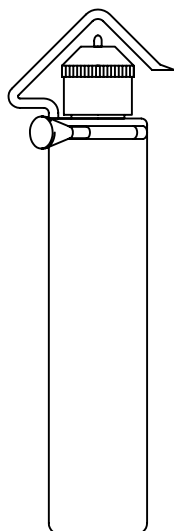

NOTE NOTA		ALFA'R CODE CÓDIGO ALFA'R
for cables $\varnothing 4.5... \varnothing 25$	para cables $\varnothing 4.5... \varnothing 25$	V-EIN-PC-U-A
for cables $\varnothing 25... \varnothing 36$	para cables $\varnothing 25... \varnothing 36$	V-EIN-PC-U-B
spare blade	cuchilla de recambio	V-EIN-PCR-U

peladora con cassette
de cuchillas

blades cassette stripping tool

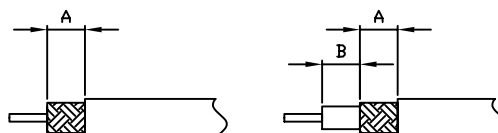
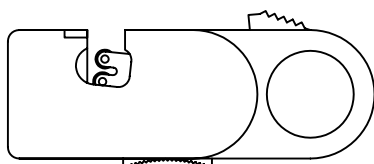

TOOL HERRAMIENTA		ALFA'R CODE CÓDIGO ALFA'R
for cables $\varnothing 2.5$ [.098]... $\varnothing 8$ [.315]	para cables $\varnothing 2.5... \varnothing 8$	V-EIN-PC-A

ACCESSORIES ACCESORIOS	A	B	COLOUR COLOR	ALFA'R CODE CÓDIGO ALFA'R
cassettes	3.9 [.154]	--	grey gris	V-EIN-PCR-A-GS
	6 [.154]	--	red rojo	V-EIN-PCR-A-RG
	12 [.472]	--	yellow amarillo	V-EIN-PCR-A-GC
	6.5 [.256]	--	blue azul	V-EIN-PCR-A-BU
	7.1 [.280]	5.1 [.201]	green verde	V-EIN-PCR-A-VD
	7.5 [.295]	3.5 [.138]	brown marrón	V-EIN-PCR-A-MR
	8 [.315]	3.7 [.146]	orange naranja	V-EIN-PCR-A-TA
	6 [.236]	6 [.236]	light green verde claro	V-EIN-PCR-A-VC
	8.6 [.339]	2.3 [.091]	black negro	V-EIN-PCR-A-NG
cover with adjustment screws		tapa con tornillos de regulación	V-EIN-PCR-A-A	

peladora con longitud variable
(de 1mm a 1mm)

*changeable lenght stripping tool
(step by step
1mm[.039] to 1mm[.039])*

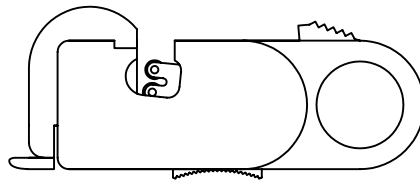

NOTE		ALFA'R CODE
NOTA		CÓDIGO ALFA'R
∅ min. 2.5mm [.098] ∅ max. 8mm [.315]		V-EIN-PC-B
spare blade box	porta cuchillas de repuesto	V-EIN-PCR-B-A
spare blades kit	juego cuchillas de recambio	V-EIN-PCR-B-B

peladora a distancias fijas

fixed distances stripping tool

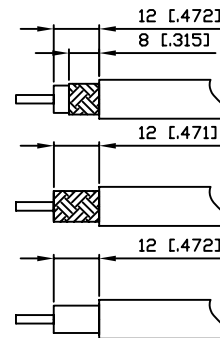
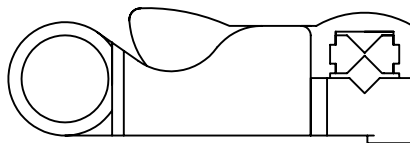

NOTE		ALFA'R CODE
NOTA		CÓDIGO ALFA'R
∅ min. 6mm [.236] ∅ max. 10.5mm [.413] (RG-59...RG-213)		V-EIN-PC-C

peladora con longitud variable

changeable lenght stripping tool

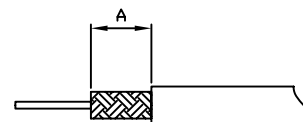
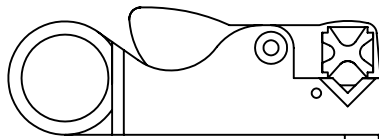

NOTE		ALFA'R CODE
NOTA		CÓDIGO ALFA'R
RG-58	4 [.157]	V-EIN-PC-D
RG-59; RG-62	6 [.236]	
RG-6	8 [.315]	
	12 [.472]	

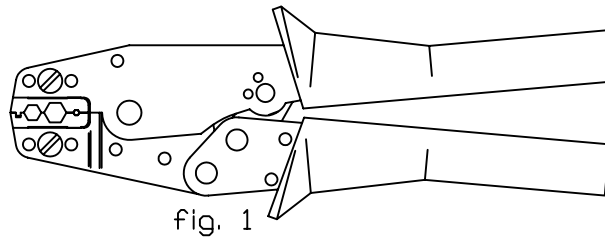

fig. 1

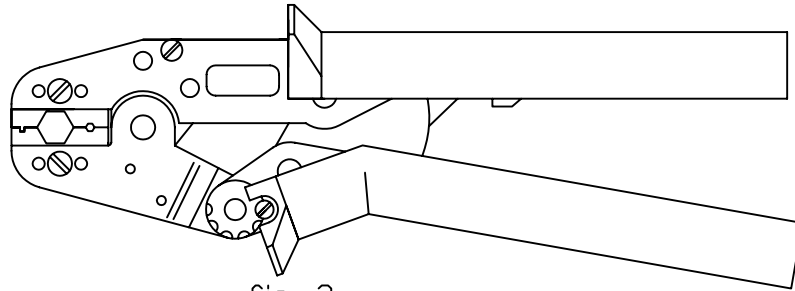

fig. 2

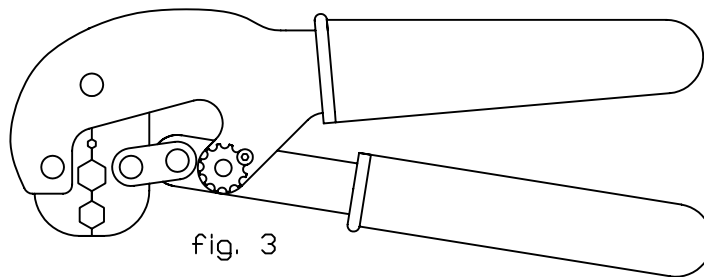

fig. 3

CABLE GROUP GRUPO CABLE	ALFA'R CODE CÓDIGO ALFA'R	FIG. FIG.	NOTE NOTA
16,18	A-EIN-C-1-C61	1	<i>see pag. 8</i> ver pág.. 8
25,25A,26,26B,27	A-EIN-C-1-641		
	A-EIN-C-1-642		
25,25A,26,26B,27,31,35,36,36A	A-EIN-C-1-63K		
31,35,36,36A,45,50,50A,54	A-EIN-C-1-931		
	A-EIN-C-1-932		
31,47	A-EIN-C-1-H3K		
31,35	A-EIN-C-1-HJK		
35,60,61	A-EIN-C-1-JIK		
47,50,50A,54,59,60,61,61D	A-EIN-C-1-341		
	A-EIN-C-1-342		
	V-EIN-C-5-EFG	3	
67,68,74	A-EIN-C-1-51	1	
	A-EIN-C-1-52	1	
	V-EIN-C-5-EFG	3	
84,88	A-EIN-C-2-B2	2	
99,99A,102,103,103A,108,108A,109	A-EIN-C-2-D2	2	
99A,102,103A,108A	V-EIN-C-5-EFG	3	

herramienta sin matriz

tool without die

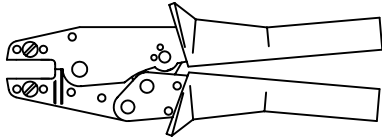

fig. 1

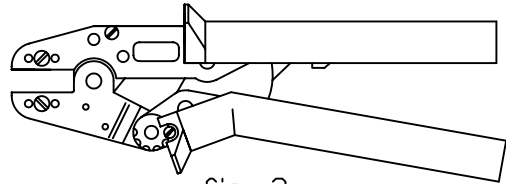
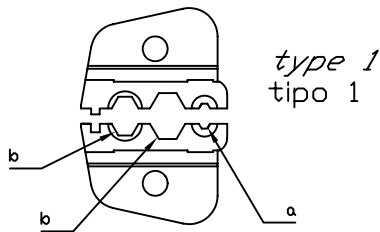

fig. 2

CABLE GROUP GRUPO CABLE	ALFA'R CODE CÓDIGO ALFA'R	FIG. FIG.	PAIR OF DIES PAREJA DE MATRICES
≤ 74	A-EIN-C-1	1	type 1 tipo 1
> 74	A-EIN-C-2	2	type 2 tipo 2

pareja de matrices

pair of dies



type 1
tipo 1

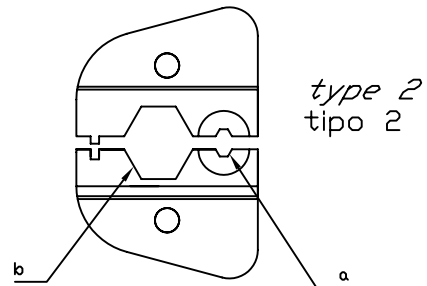

type 2
tipo 2

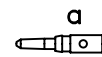
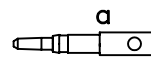
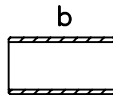
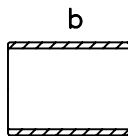

A-EIN-C-0-341

crimp ferrule (b) / tubo crimp (b) and crimp pin (a) / pin crimp (a)

CABLE GROUP GRUPO CABLE	TYPE TIPO	FIG. b	STANDARD	FIG. a	PIN
16,18	1	C 6	→	1	∅2.2 [.087]
25,25A,26,26B,27		6 4	→	1/2	∅2.2 [.087]/∅3 [.118]
25,25A,26,26B,27 / 31.35.36.36A		6 3	→	K	∅0.9[.035]/∅1.2[.047]/∅1.6[.063]
31,35,36,36A / 45,50,50A,54		9 3	→	1/2	∅2.2 [.087]/∅3 [.118]
31 / 47		H 3	→	K	∅0.9[.035]/∅1.2[.047]/∅1.6[.063]
31 / 35		H J	→		
35 / 60,61		J I	→		
47,50,50A,54 / 59,60,61,61D		3 4	→	1/2	∅2.2 [.087]/∅3 [.118]
67,67A,68,74		5	→		
84,88		2	B	→	2
99,99A,101,102,103,103A,108,108A,109	D		→		

Herramientas de montaje
para insertar serie F y 5/8"
en cable de PE

*Assembly tools
to insert F and 5/8"
series in PE cable*

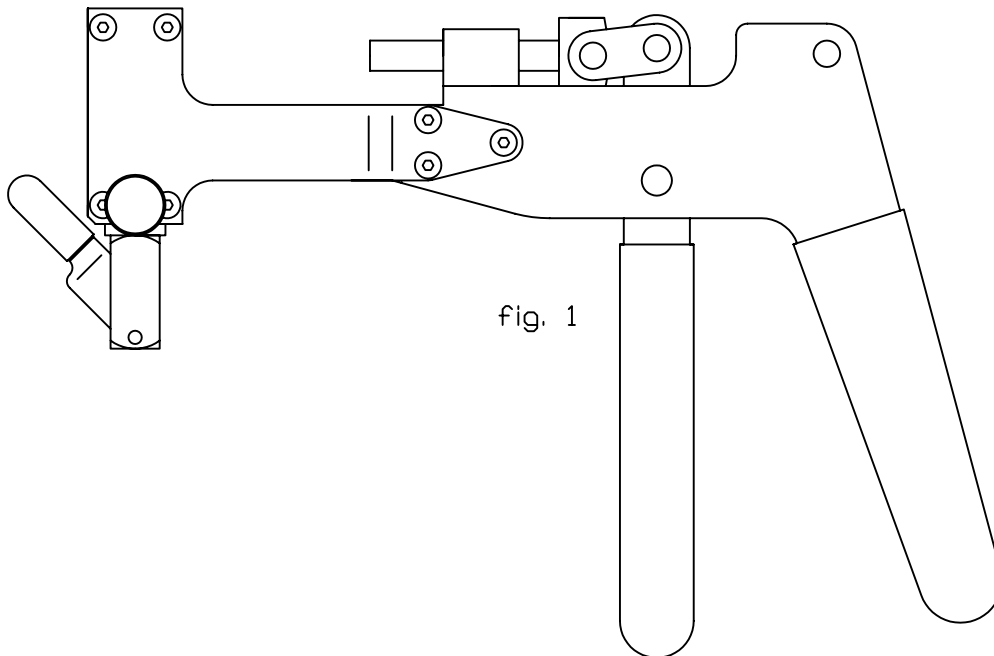

fig. 1

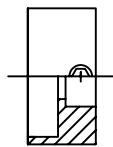

fig. 2

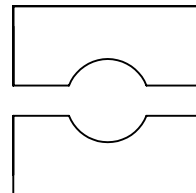
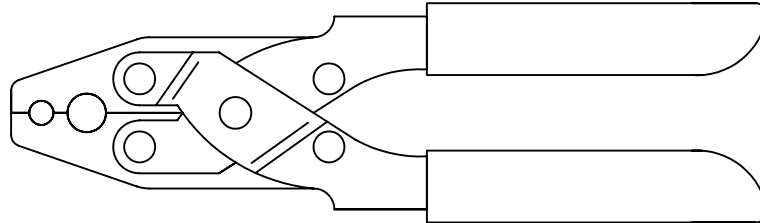

fig. 3

CABLE CABLE	ALFA'R CODE CÓDIGO ALFA'R	FIG. FIG.	NOTE NOTA
	A-EIN-MT-F	1	<i>tool</i> herramienta
	A-EIN-MTR-5/8	2	<i>5/8" adapter</i> adaptador 5/8"
RG-59; 0.8/3.7/6.1	A-EIN-MTR-F-61	3	<i>clamp for cable</i> mordaza para cable
RG-6; 1.0/4.6/6.9; 1.0/4.6/7.1	A-EIN-MTR-F-68		
1.0/6.6/8.8	A-EIN-MTR-F-88		
1.6/7.3/9.9	A-EIN-MTR-F-99A		
RG-11 CATV; 14/8 CATV	A-EIN-MTR-F-102		
RG-11 MIL; 1.6/7.1/10.3	A-EIN-MTR-F-103A		

herramienta para montar
 racord SMA
 (A-SMA-10S36X-50-A)

*tool to set up SMA
 nut tourque
 (A-SMA-10S36X-50-A)*



<i>NOTE</i>		<i>ALFA`R CODE</i>
NOTA		CÓDIGO ALFA`R
<i>elastic compression washer</i>	compresión arandela elástica	A-EIN-MT-SMA

llave para tuerca
 (hembra 1.6/5.6)

*nut tool
 (1.6/5.6 jack)*

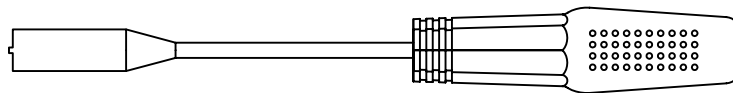

	<i>ALFA`R CODE</i>	
	CÓDIGO ALFA`R	
	V-EIN-MT-1.6	

llave sujeción F macho
 para facilitar entrada cable

*to make easy
 cable assembly*

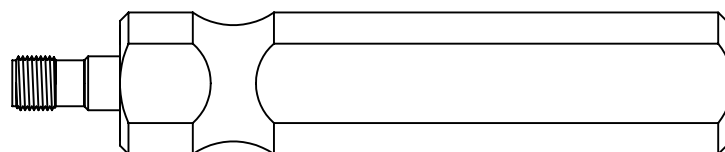

	<i>ALFA`R CODE</i>	
	CÓDIGO ALFA`R	
	V-EIN-MT-F-A	

llave fija
(ancho reducido)

spanner
(reduced wide)

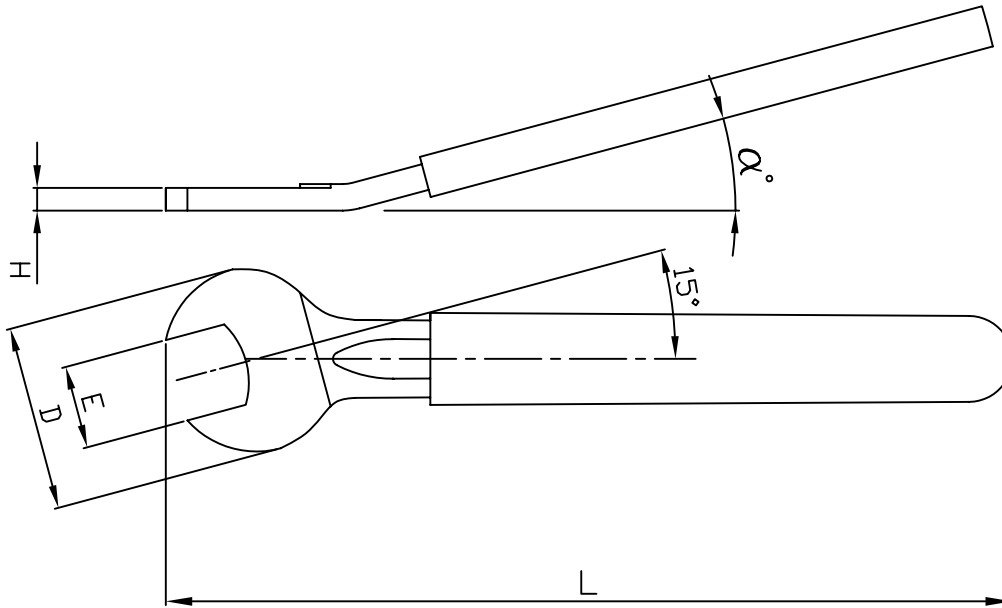

E	H	D	L	α	ALFA'R CODE CÓDIGO ALFA'R	
5 [.197]	2 [.079]	15.5 [.610]	60 [2.362]	15	A-EIN-CF-5X2	
6 [.236]			73 [2.874]		A-EIN-CF-6X2	
7 [.276]	3 [.118]	17 [.669]	77 [3.031]		A-EIN-CF-7X3	
8 [.315]			94 [3.701]		A-EIN-CF-8X3	
9 [.354]			20.5 [.807]		99 [3.898]	A-EIN-CF-9X3
10 [.394]			22 [.866]		105 [4.134]	A-EIN-CF-10X3
11 [.433]			24.5 [.965]		110 [4.331]	A-EIN-CF-11X3
12 [.472]			26 [1.024]		124 [4.882]	A-EIN-CF-12X3
13 [.512]	4 [.157]	30 [1.181]	125 [4.921]		A-EIN-CF-13X3	
14 [.551]			140 [5.512]		A-EIN-CF-14X4	
15 [.591]			32.5 [1.280]		141 [5.551]	A-EIN-CF-15X4
16 [.630]			34 [1.339]		145 [5.709]	A-EIN-CF-16X4
17 [.669]			35.5 [1.398]		155 [6.102]	A-EIN-CF-17X4
18 [.709]			38.5 [1.516]			A-EIN-CF-18X4
19 [.748]	6 [.236]	40 [1.575]	170 [6.693]	A-EIN-CF-19X4		
20 [.787]			42 [1.654]	184 [7.244]	A-EIN-CF-20X4	
21 [.827]			44 [1.732]	215 [8.465]	A-EIN-CF-21X6	
22 [.866]			46 [1.811]		A-EIN-CF-22X6	
23 [.906]			48 [1.890]		A-EIN-CF-23X6	
24 [.945]			50 [1.969]		A-EIN-CF-24X6	
25 [.984]	9 [.354]	52 [2.047]	215 [8.465]	A-EIN-CF-25X9		
27 [1.063]				56 [2.205]	238 [9.370]	A-EIN-CF-27X9
30 [1.118]				62 [2.441]	261 [10.276]	A-EIN-CF-30X9
32 [1.260]				66.5 [2.618]	273 [10.748]	A-EIN-CF-32X9
1/2"	3 [.118]	26.5 [1.043]	125 [4.921]	0	A-EIN-CF-1/2X3	